

Catalog Number :

Project Name :

Note :

Date :

Type :

DESCRIPTION

Ultra -thin design, lamp thickness only 0.98 ". The die casting surface ring, excellent heat dissipation.
 Fixture design has infrared sensor interface;
 5 adjustable color temperature;
 It is suitable for office, family, hotels, corridors, shopping centers, schools, books and other places.



11"



13"



BASED ON SAMPLE SETTING. ACTUAL LUMENS MAY VARY.

MODEL	SIZE	WATTAGE	5CCT	LUMENS
BRT-1121-CCT-WHT	11inch	21W	2700K	1660lm
			3000K	1767lm
			3500K	1883lm
			4000K	1968lm
			5000K	1955lm

MODEL	SIZE	WATTAGE	5CCT	LUMENS
BRT-1324-CCT-WHT	13inch	24W	2700K	1917lm
			3000K	2027lm
			3500K	2159lm
			4000K	2205lm
			5000K	2173lm

TECHNICAL SPECIFICATION

VOLTAGE	120V
POWER FREQUENCY	60Hz
POWER FACTOR	>0.9
5CCT	2700K 3000K 3500K 4000K 5000K
CRI	90
BEAM ANGLE	120°
MATERIAL	Die casting AL+PS
COLOR	White
LIFESPAN	≥50,000hours
OPERATING TEMP	(-4°F~ 113°F) -20~45°C
DIMMING	Triac Dimmable
RATING	Suitable for Wet Locations
WARRANTY	5 year limited

TRIM RING REPLACEMENT (SOLD SEPARATELY)



Brushed nickel



Black



Bronze

FEATURES

- Emits evenly, without halo and shadow;
- Fit 2.75 or 3.5 inch J-Box;
- Support surface mount;
- Die-cast trim;

STYLISH AND SLIM DESIGN

This ultra bright LED Flush Mount is only 0.79 inch thickness.
 The smooth surface is suitable for a variety of decorative styles.

DIMMING

Compatible with most triac dimmers to give user a smooth 100%-10% dimming to choose the desired brightness.
 Please check the recommended dimmer list in next page.

ELECTRICAL

This fixture is built with the highest quality 120V drivers, ensuring energy efficiency.

ENERGY SAVINGS

80% more energy savings than halogen lamps.

LISTING

ETL Listed.



Ceiling Light Series II

5CCT Flush Mount

Catalog Number :

Project Name :

Note :

Date :

Type :

Die-cast trim

Precision casting, excellent heat dissipation, high corrosion; lamp thickness only 0.98".



Color temperature optional

2700K-5000K

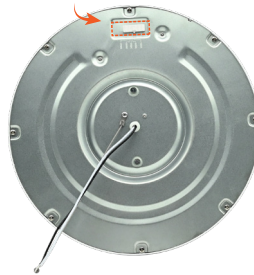

Mounting bracket

With multiple apertures, can be installed into any 2.75 or 3.5inch junction box.

2.75" Junction Box installation hole

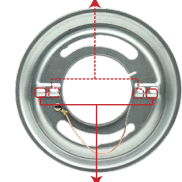

3.5" Junction Box installation hole

INSTALLATION STEPS

1.Remove the bracket from the fixture by twisting in anticlockwise direction, see Fig1.

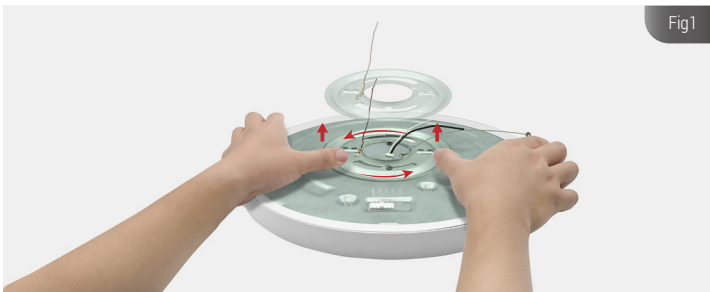

2.Refer to the hole position on the bracket and do the matching to J-Box. Attach them with screws, see Fig2.



3.Connect supply wires to wires on fixture/bracket with wire nuts. Attach white to white, black to black, and copper wire to green wire as grounding connection, select lamp color desired with the CCT switch, see Fig3.

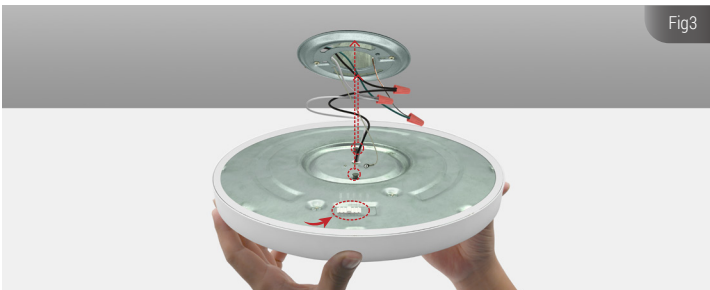

4.Arrange the wires into the J-Box. Align the 2 screw points on fixture to the wider side of long holes on the bracket, twist in clockwise direction until fixing stable. Turn on the power after installation, check the fixture can work well, see Fig4.

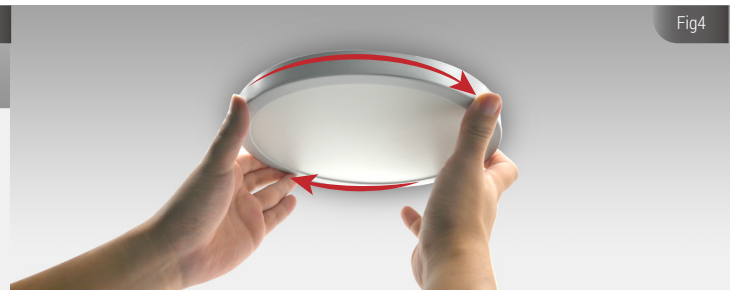

RECOMMENDED DIMMER

LUTRON						LEVITON	
TG-600PR-WH	SLV-600P-AL	MSCL-OP153M	CT-103PR-WH	DVWCL-153PH	DVRF-6L	6672	RNL06
CTCL-153PDH-WH	GT-600P	PD-6WCL	STCL-153MR	RCL-153RNL	CTCL-150H	6674	IPL06
TGCL-153PH-LA	DVCL-153P	S2-LFSQH-WH	MACL-153MA			DSL06	

DIMENSION

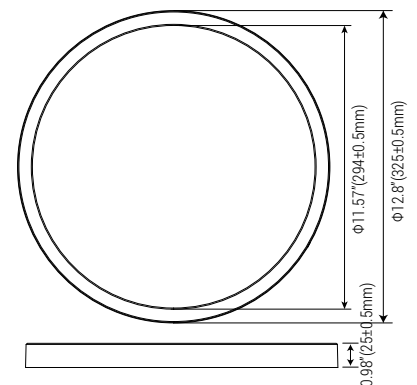
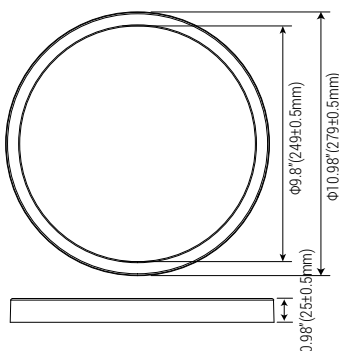

Specification subject to change without notice